

Hybrid Stepper Motor 86BYGH450D-02A

Mechanical Dimensions:

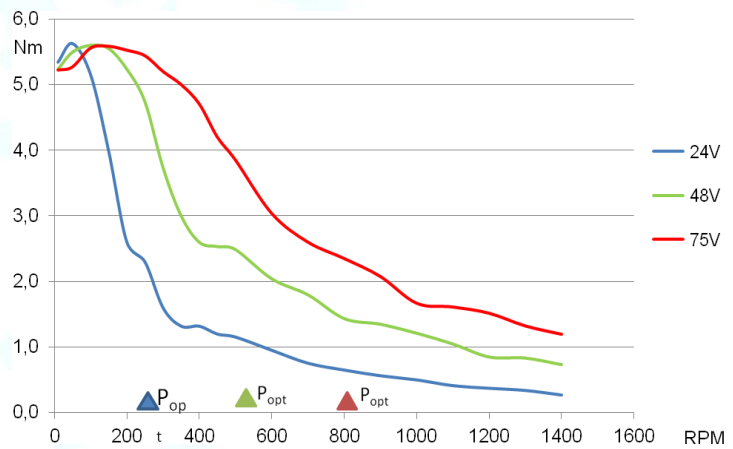
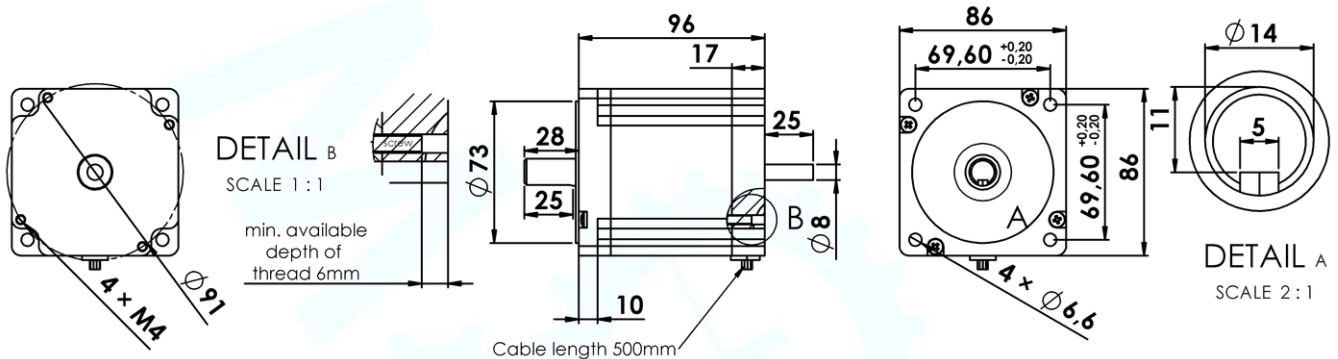

Electrical Specifications:

	Unipolar	Bipolar Serial	Bipolar Parallel
No. of phases	4	2	2
Rated Voltage (V)	4.2	6	3
Current (A)	4.5	3.2	6.4
Resistance ±10% (Ω)	0.94	1.88	0.47
Inductance ±20% (mH)	4.2	16.8	4.2
Holding Torque coils on DC (Nm)	5.3	7.5	7.5
Dynamic Torque (Nm)	3.9	5.5	5.5
Rotor Inertia (gcm ²)	2700	Allowable Axial Load (N)	15
Insulation Class	B	Allowable Radial Load (N)	75
Insulation Resistance	100MΩ, 500VDC	Max. Voltage Input (VDC)	60
Weight (kg)	3.0	Max. Starting Pulse Rate	3333 Pulse/ sec.
Step Angle (°)	1.8	Max. Slewing Pulse Rate	16666 Pulse/ sec.
Pictographs / Symbols	<p>Hot Surface: Let device cool down before maintenance</p>	<p>Operations may only be executed by qualified Electricians</p>	<p>Read data and instructions carefully before initial operation</p>
Piktogramme / Symbole	<p>Heiße Oberfläche: Gerät vor der Wartung abkühlen lassen</p>	<p>Arbeiten dürfen nur von qualifizierten Fachkräften ausgeführt werden</p>	<p>Lesen Sie die Daten und Anweisungen vor der ersten Inbetriebnahme sorgfältig durch</p>

19.12.2023